

ABU DHABI DESERT CHALLENGE 2022

YAS MARINA CIRCUIT - Overview

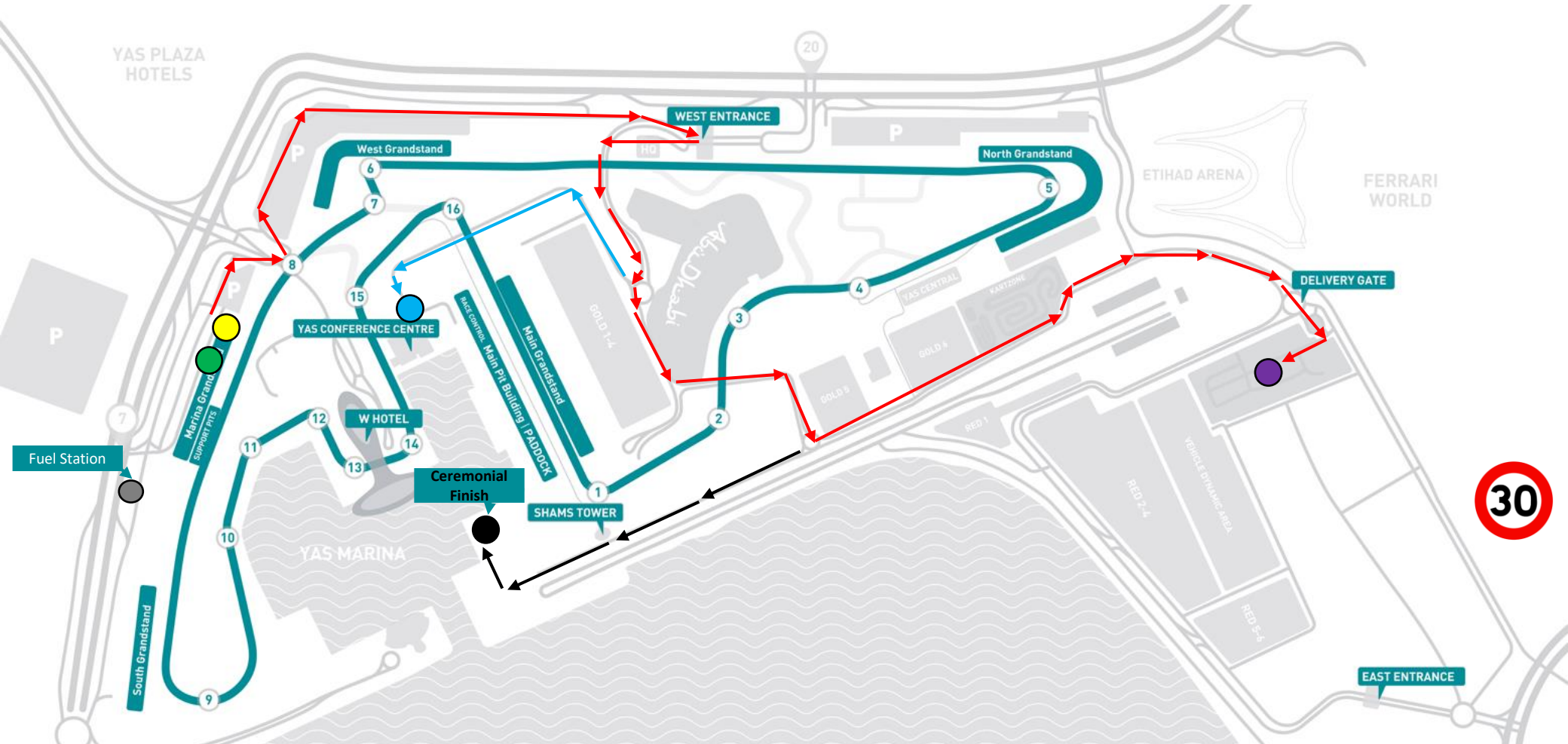

- | | | | |
|----------------------|-----------------------------|------------------------|-------------------|
| Event Route | ADDC RALLY HQ/ SERVICE PARK | FIM MOTO SCRUTINEERING | Fuel Station |
| YAS CONFERENCE ROUTE | YAS PRESS CONFERENCE CENTRE | FIA AUTO SCRUTINEERING | Ceremonial Finish |

ABU DHABI DESERT CHALLENGE 2022

YAS Marina Circuit (Support Pit) - March 1st to March 6th



Entry/Exit Gate 7

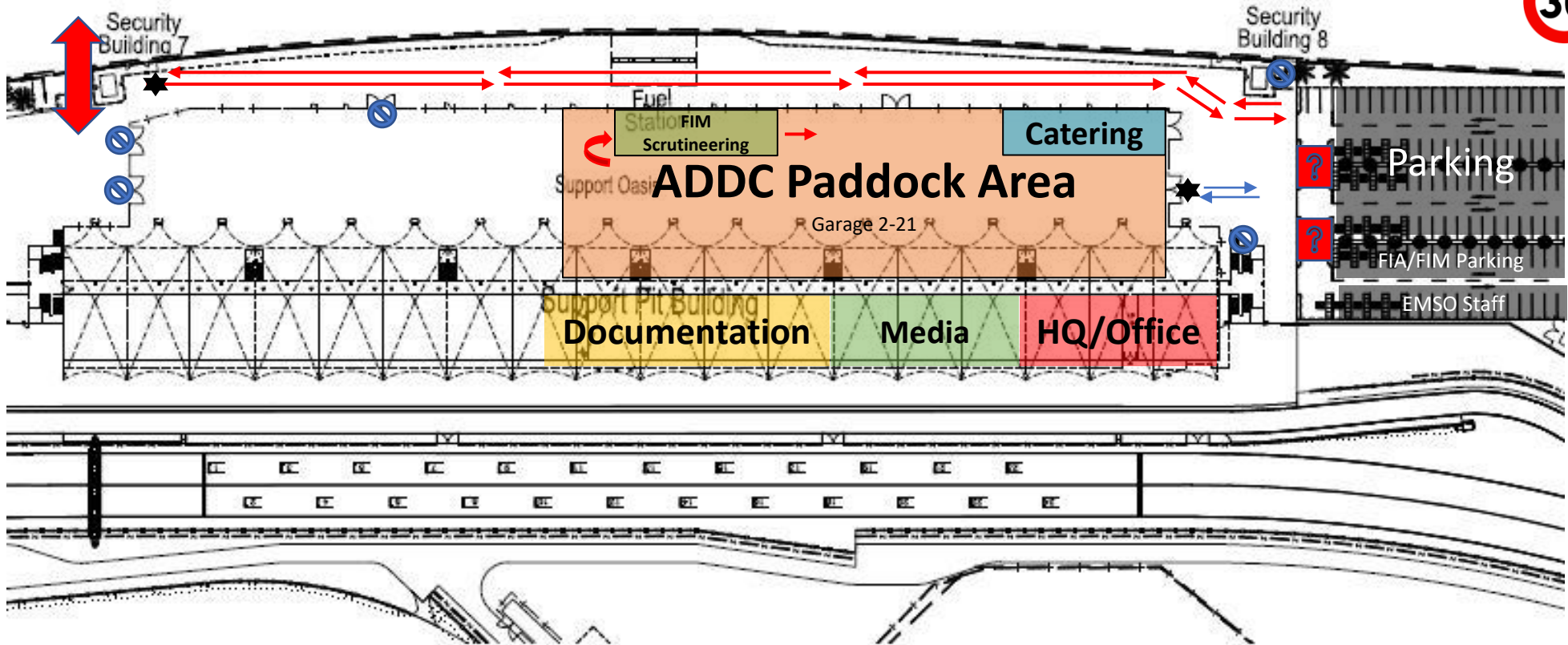

NO Entry

Covid Check IN

Entry/ Exit after Registration

Security Check Point

Traffic Flow

Speed Limit

ABU DHABI DESERT CHALLENGE 2022

YAS Marina Circuit (Refueling Area) - March 3rd to March 6th

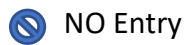
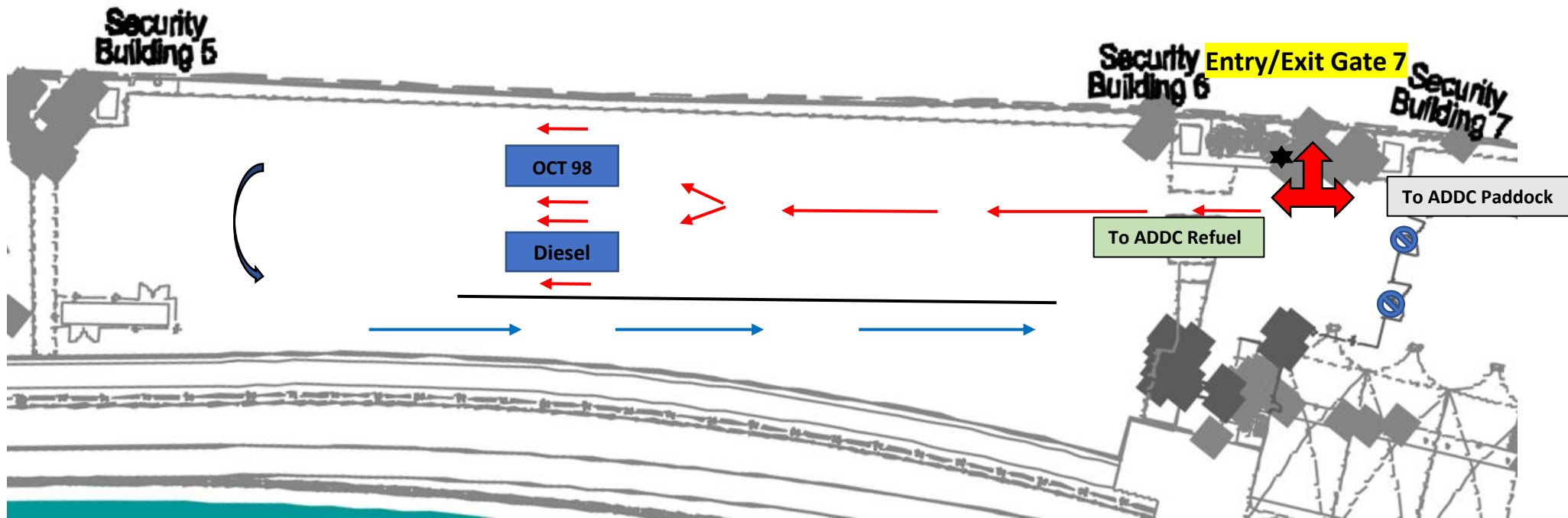

NO Entry



Exit Route



Security Check Point



Entry Route



Speed Limit

ABU DHABI DESERT CHALLENGE 2022

YAS Marina Circuit (HQ/Office) First Floor - March 1st to March 6th

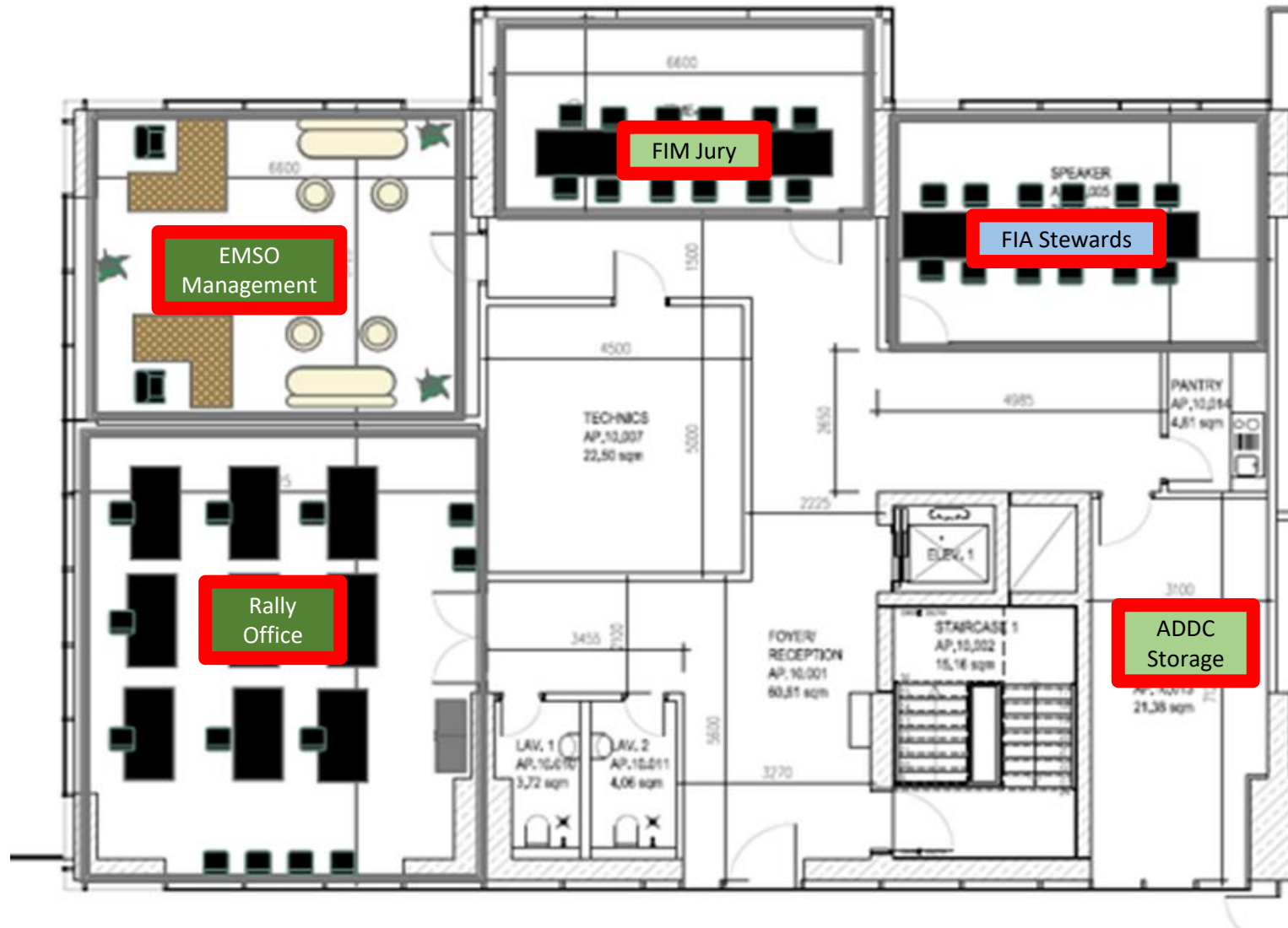

ABU DHABI DESERT CHALLENGE 2022

YAS Marina Circuit (HQ/Office) Ground Floor - March 1st to March 6th

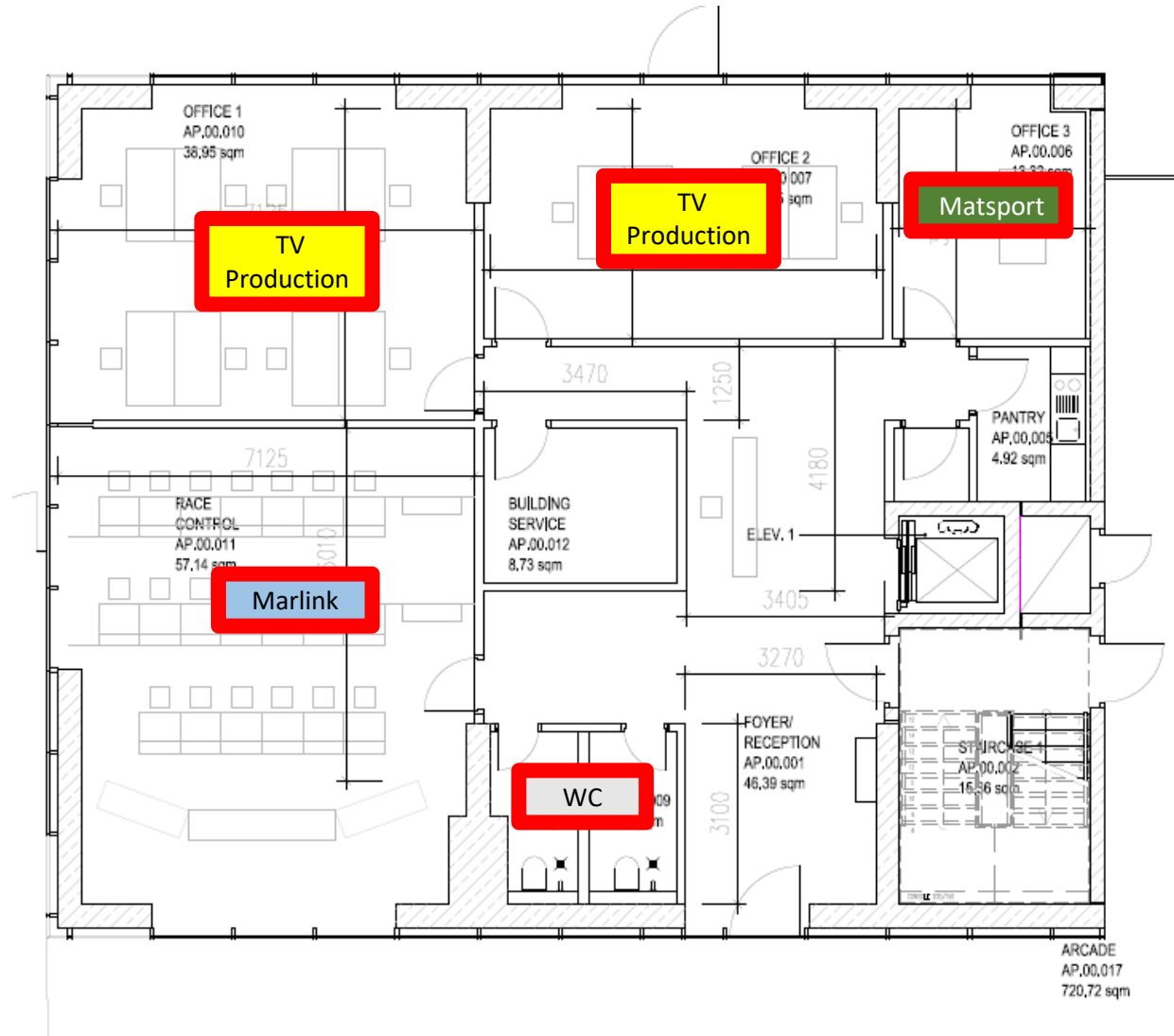

ABU DHABI DESERT CHALLENGE 2022

YAS Marina Circuit (Support Paddock Suite 1) - March 1st to March 10th



Briefing Room

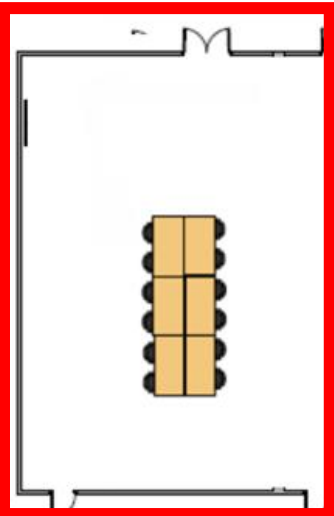

Documentation

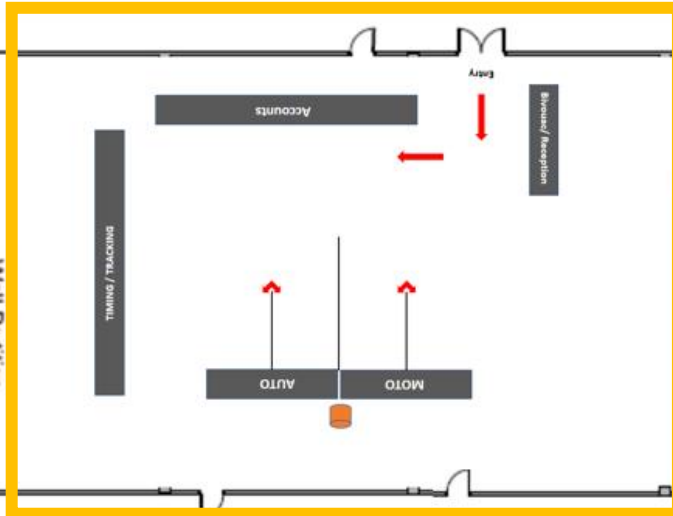

Media

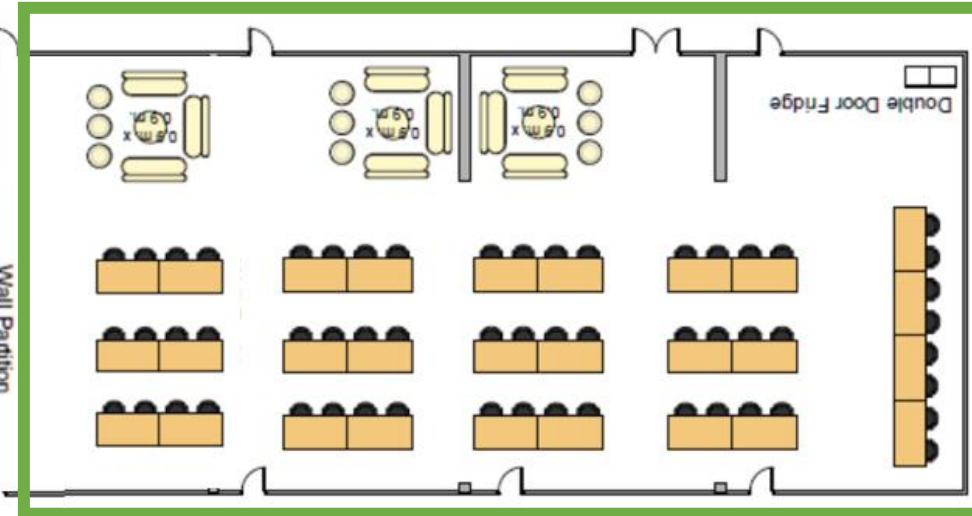

ABU DHABI DESERT CHALLENGE 2022

YAS Marina Circuit (Catering) - March 1st to March 6th

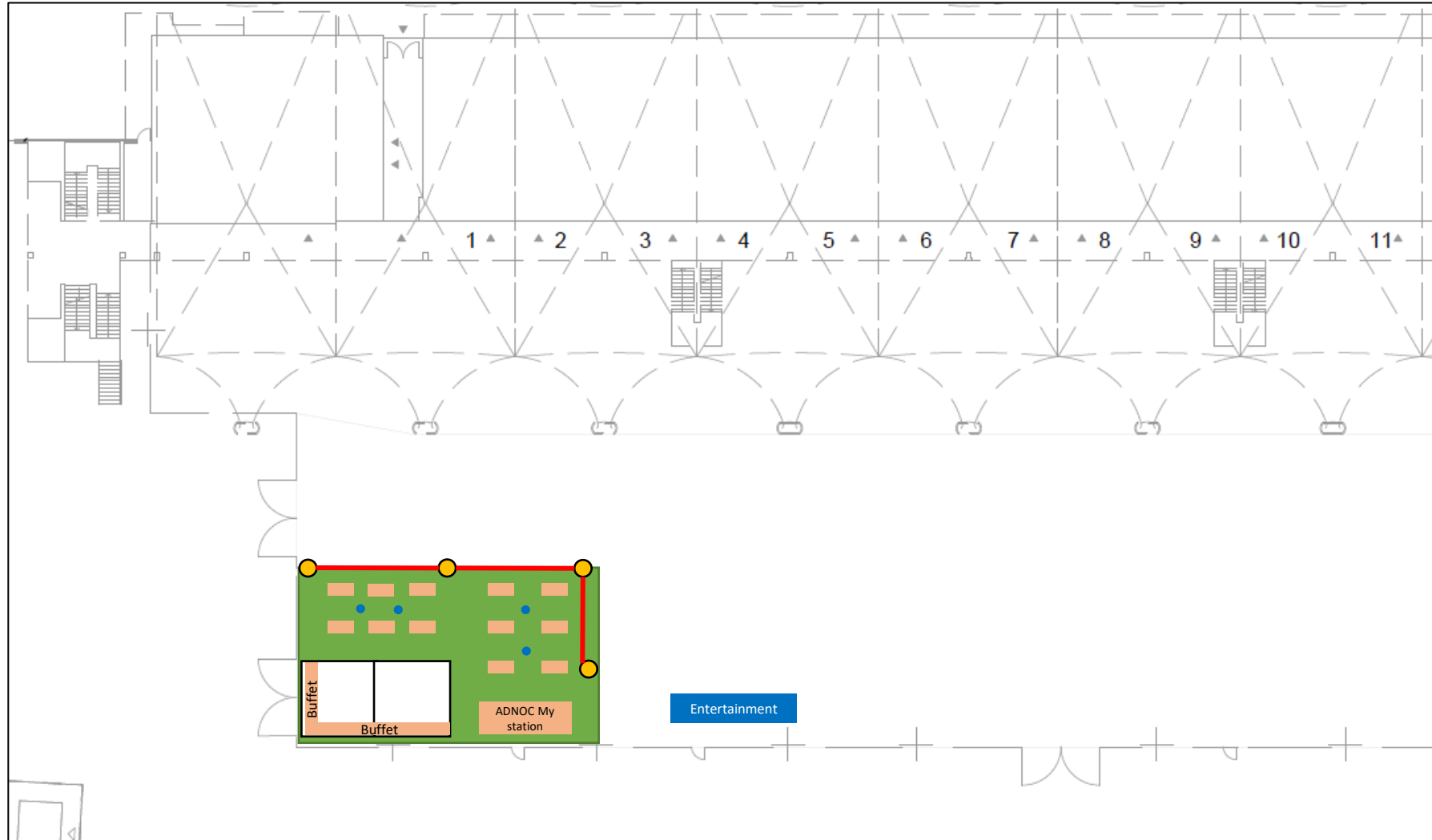

ABU DHABI DESERT CHALLENGE 2022

YAS Marina Circuit (Press Conference) Hall 1 - March 5th

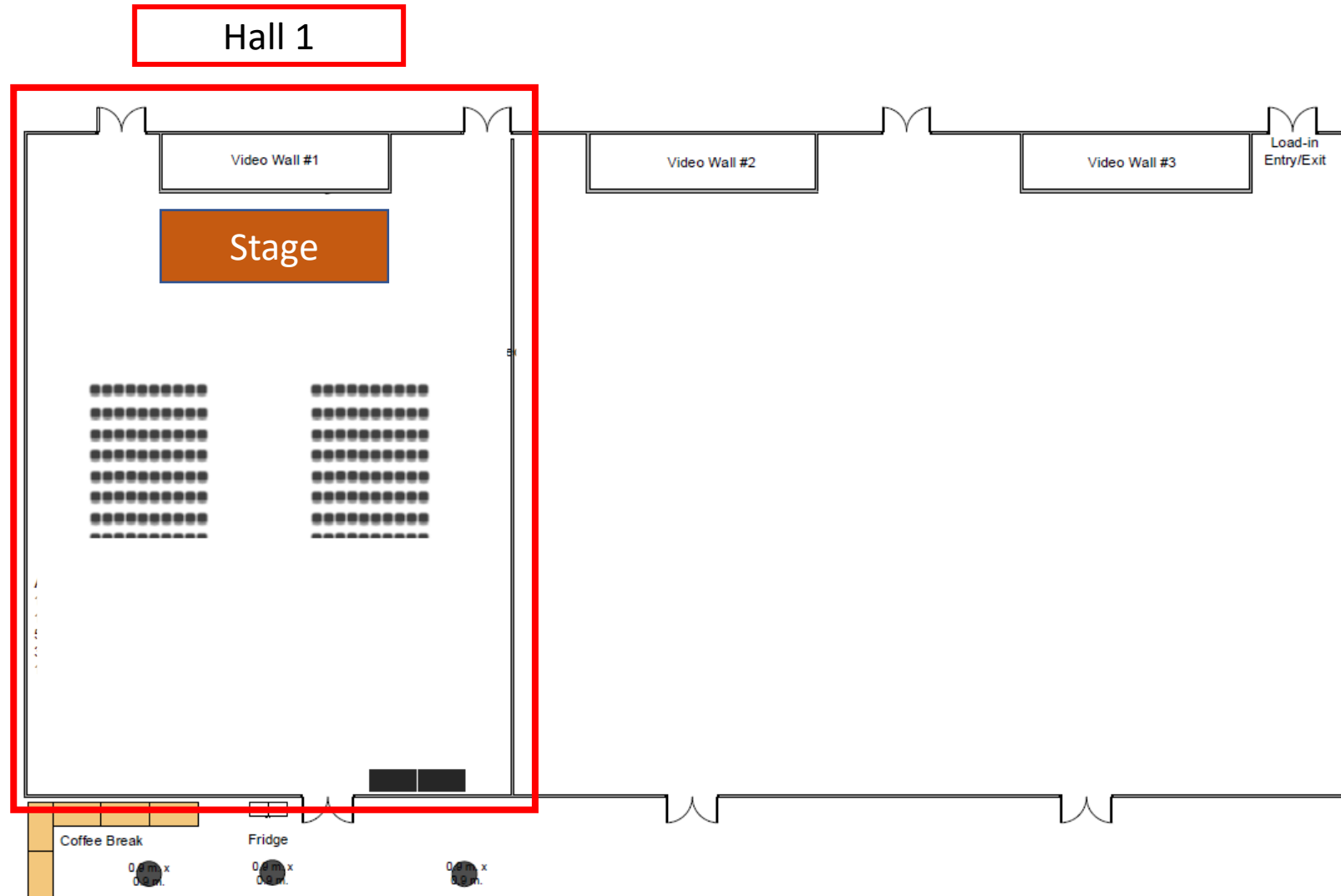

ABU DHABI DESERT CHALLENGE 2022

YAS Marina Circuit (Briefing) Hall 1 and 2 - March 5th



Hall 1 & 2

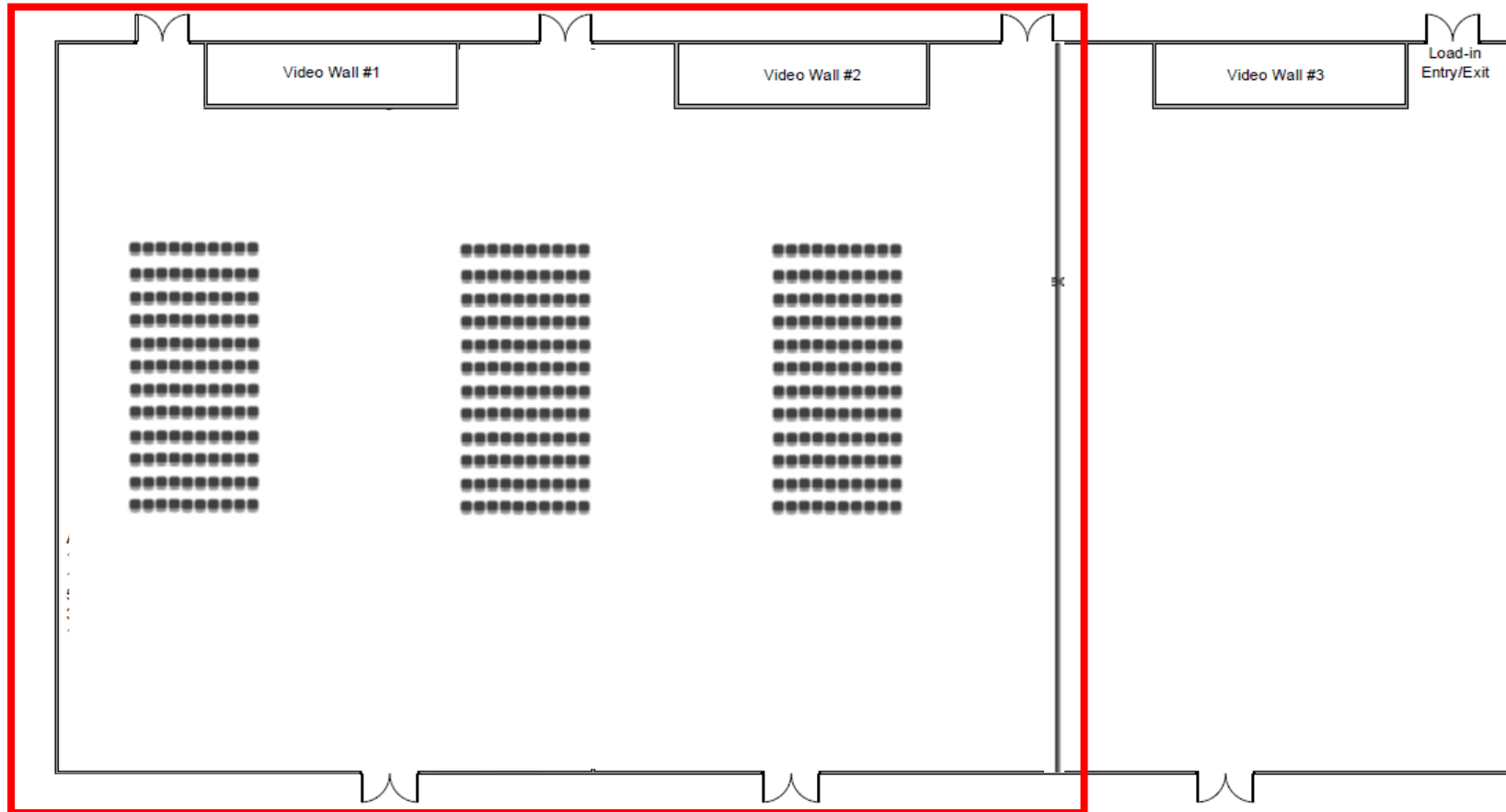

ABU DHABI DESERT CHALLENGE 2022

Bivouac Map - March 6th – 10th

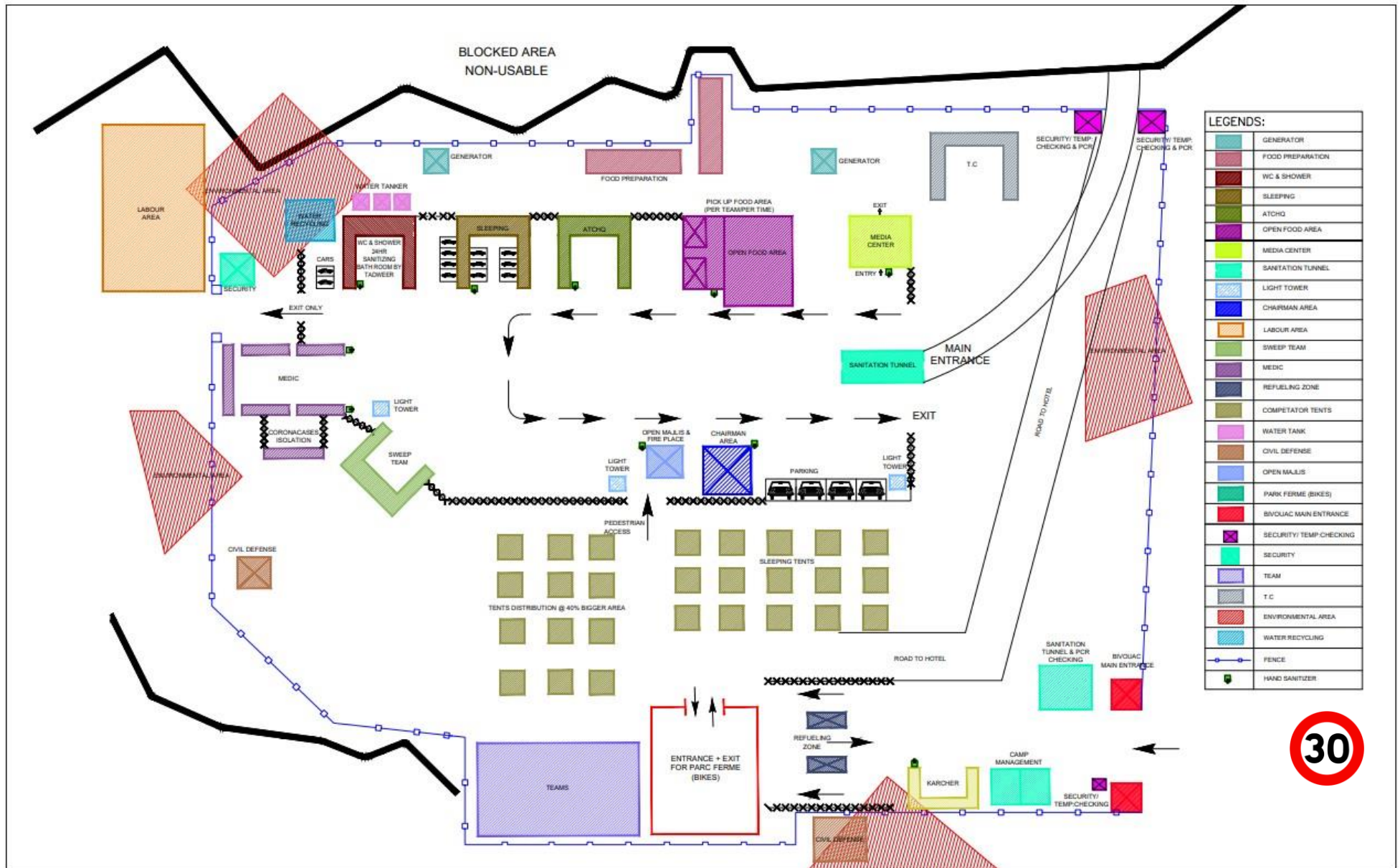

ABU DHABI DESERT CHALLENGE 2022

Rally Control at QAS - March 6th – 10th

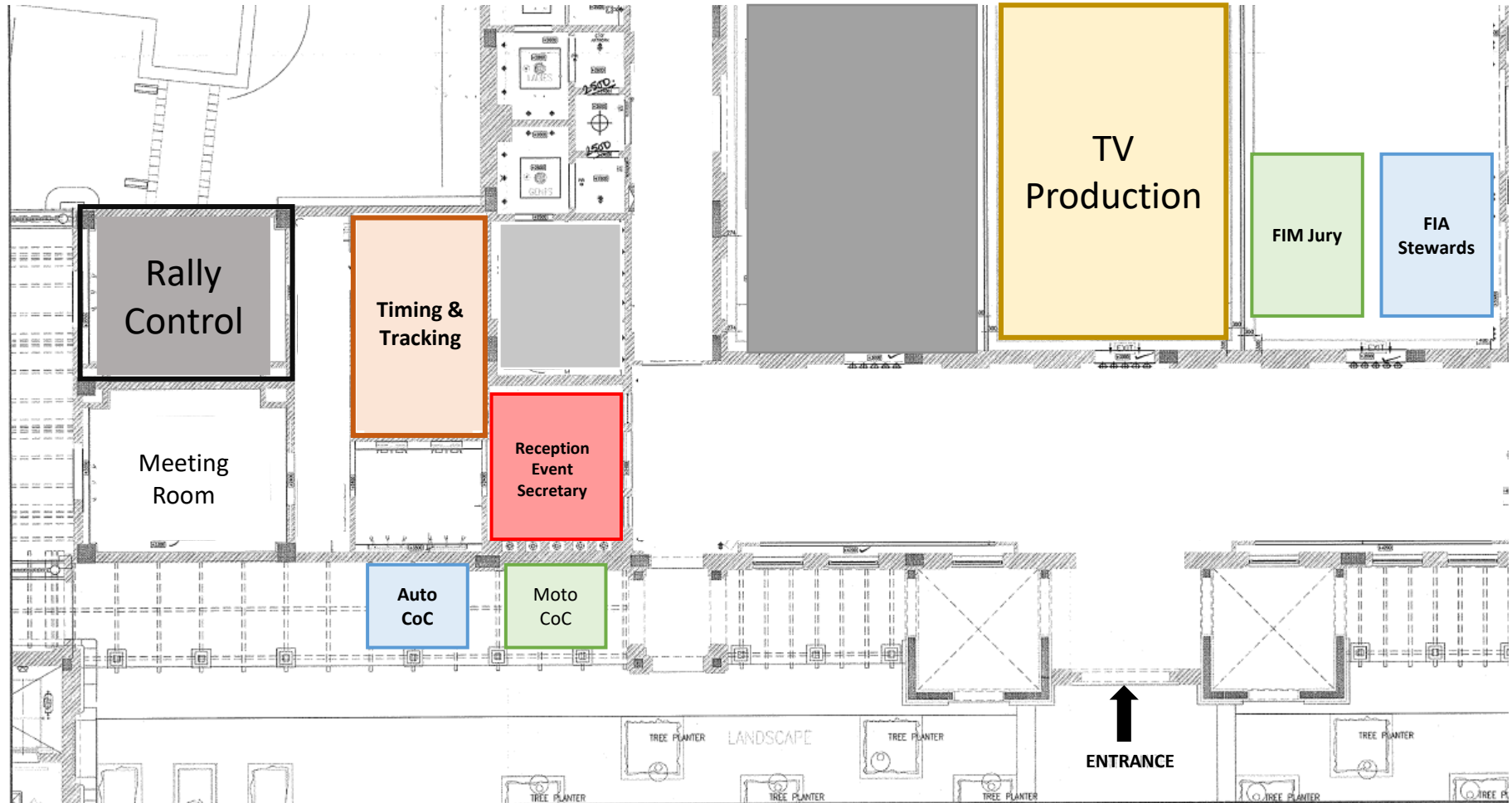

ABU DHABI DESERT CHALLENGE 2022

YAS Marina Circuit (Support Pit) - March 10th

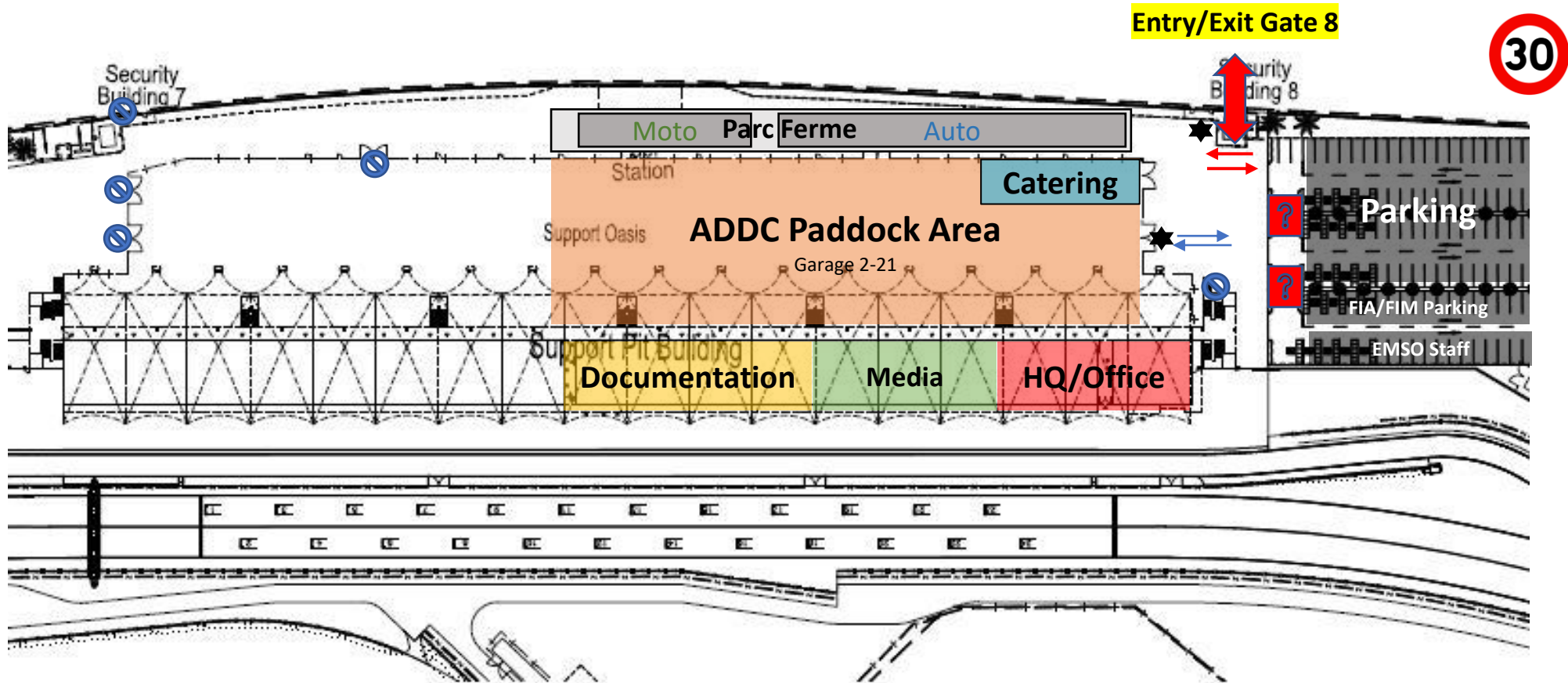

 NO Entry

 Covid Check IN

→ Entry/ Exit after Registration ★ Security Check Point

→ Traffic Flow

 Speed Limit